

Austrittsfilter
Exhaust filters

GV 200

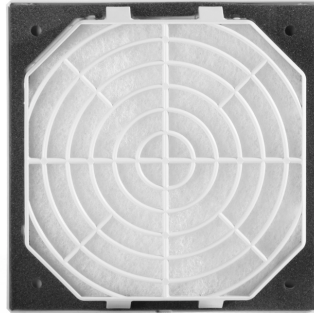

Technische Daten / Technical data:	
Temperaturbereich Temperature range	-20...+65 °C
Farben colours	RAL 7035 (Standard), RAL 7032
Schutzart Degree of protection	IP 54
Zulassung Approval	UL, CE

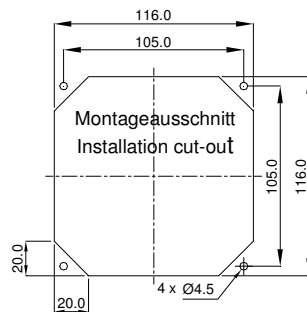
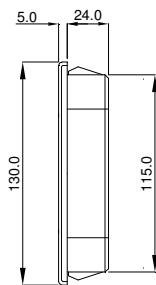
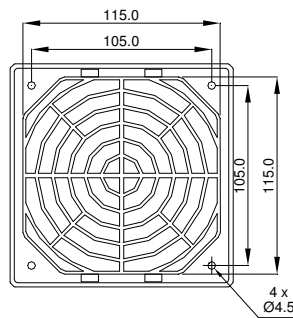
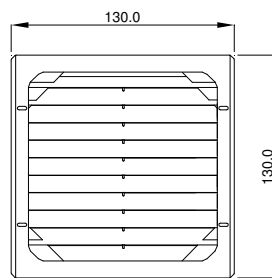

Achteckiger Ausschnitt und Bohrungen
nur bei Schraubbefestigung

Octagonal cut-out and
drill-holes are only necessary for
screw-fastening

Zubehör / Accessories:

Dichtung / gasket (enthalten / included)
Ersatzfiltermatte / Replacement filter mat

D 200
AM 235P, AM 200P

Rev. 03/09

